



Sundram Fasteners Limited

RETAIL PRICE LIST

NO.SF/SOCKET/02/2021

SOCKET PRODUCTS-STANDARD APPLICATION

Effective 1st September 2021

SOCKET PRODUCTS

Marketing Office	Registered Office
98A, Dr.Radhakrishnan Salai, 7th Floor, Auras Corporate Centre, Mylapore, Chennai 600 004	98A, Dr.Radhakrishnan Salai, 7th Floor, Auras Corporate Centre, Mylapore, Chennai 600 004

Factories			
Padi Unit	Pondicherry Unit	Krishnapuram Unit	Uttarkhand Unit
Padi, Chennai 600050 GST No.: 33AAACS8779D1Z7	Korkadu, Villianur (via) Pondicherry 605110 GST No.: 34AAACS8779D1Z5	Krishnapuram, Aruppukottai Road, Aviyur 626 160 (TN) GST No.: 33AAACS8779D1Z7	Plot No.60 Sector 11 Intrgrated Indl. Estate Pantnagar Rudrapur 263 153 GST No: 05AAACS8779D1Z6
WEF & INFRA UNIT			
135/3,136/1 - Mandagapattu Road, Mitta Mandagapattu Village Villupuram Dist. 605106 (TN) GST No: 33AAACS8779D1Z7			
CIN No. L359999TN1962PLC004943 GST No: 33AAACS8779D1Z7 www.sundram.com Email: marketing@fasteners.sfl.co.in			





GENERAL CONDITIONS FOR SALE

(RELATED TO PRICE LIST NO.SF/SOCKET/02/2021)

All quotations, purchase orders or requests are subject to the following terms and conditions of sale. Any qualifications to these conditions made by the Buyer will not apply unless expressly accepted in writing by Sundram Fasteners Limited (hereinafter, called as "SFL"). These General Terms and Conditions of Sale shall not be applicable where SFL and Buyer had entered into Product Sale/Purchase/Supply Agreement. In the event of any dispute, ambiguity in interpretation or claim between SFL and the Buyer the Product Sale/Purchase/Supply Agreement and its specific terms shall apply first. To the extent that the individual Product Sale/Purchase/Supply Agreement and its specific terms are silent, the General Terms and Conditions herein shall apply. If the General Terms and Conditions of Sale are silent, the general rules of the governing law shall apply and prevail.

1. ORDER AND ACCEPTANCE

All orders placed by the Buyer shall be subject to SFL's acceptance. SFL shall be at liberty to accept or refuse any order in full or in part without assigning any reasons whatsoever. Orders once accepted by SFL shall not be cancelled by the Buyer unless consented to or by SFL in writing. None of these terms and conditions may be added to, modified, superseded or otherwise altered, except by a written instrument signed by an authorized signatory of SFL. SFL's failure to object to any of the terms and conditions which may be contained in any document of Buyer shall not be construed as a waiver of these conditions or as acceptance of any such terms and conditions.

2. PRICES AND PAYMENT

- 2.1 Prices prevailing on the date of dispatch of Goods will become applicable irrespective of the fact that Purchase order/delivery order/advance payment for the same been accepted/issued by SFL.
- 2.2 SFL reserves the right to revise the prices of Goods without any further advance notice to the Buyer or without assigning any reasons thereof.
- 2.3 SFL shall not be responsible for costs, charge, expenses, losses etc., if any, incurred by the Buyer.
- 2.4 The Prices are exclusive of GST as applicable on the Goods supplied. SFL shall collect TCS as applicable on the Goods supplied to Buyer.
- 2.5 Any taxes, cess or duties levied by Central, State, Municipal, Local or any other authority, in effect or hereinafter imposed, on the sale, transportation or delivery of the Products delivered hereunder shall be paid by Buyer, and, if directly paid by SFL, reimbursed to SFL by Buyer with retrospective or prospective effect.
- 2.6 The Cheque/Drafts/Pay Orders not accepted unless otherwise specifically agreed in writing. The Cheque/Drafts/Pay orders should be drawn by the Buyer in favour of Sundram Fasteners Limited. SFL shall not be liable to loss or theft of Cheque/Drafts/Pay orders etc., in transit.
- 2.7 Payment terms are net thirty (30) days from the date of the invoice or as mutually agreed in writing.
- 2.8 Any payments not made within due date shall be subject to a late payment charge for the period of delay beyond due date, penal interest at 18 % per annum.
- 2.9 SFL reserves its right to appropriate and adjust any sums due to the Buyer against any dues recoverable from the Buyer including delayed payment charges, if any.
- 2.10 All stipulations as to time of payment of the purchase price of Goods are the essence of the Contract.

3. LOSS OR DAMAGE

Unless otherwise agreed, the risk in the Goods shall pass from SFL to the Buyer the moment they are delivered by SFL to the Buyer or to a Carrier or any other party including Warehouse operated/identified for the purpose (whether named by the Buyer or not) including risk associated with any Goods subsequently returned to SFL. SFL accepts no liability for loss or damage to Goods once handed over to the Buyer or Carrier any other party including Warehouse operated/identified for the purpose instructed/chosen by Buyer.

4. PACKING AND TRANSPORTATION

- 4.1 Unless otherwise specified by the Buyer, SFL will select the most economical method and route of shipment. In the event that the Buyer is unable or unwilling to take delivery of all or any part of the Goods, SFL shall place them into storage with all costs, including storage, insurance, demurrage, and transportation at the Buyer's expense.
- 4.2 Packing will be in accordance with SFL/Industry standard practice and Prices quoted are for packing in cartons. SFL retains ownership of any re-usable packaging.

5. DELIVERY AND ACCEPTANCE

- 5.1 The delivery dates are tentative and no responsibility is accepted by SFL for delay in delivery or failure to deliver as per delivery schedule due to circumstances beyond SFL's control. Delivery/Despatch may be made in one lot or several lots and if made in several lots payment should be made in terms of the payment clause.
- 5.2 Goods supplied shall be deemed to have been supplied as per the Buyer's specifications unless the Buyer, within 48 hours from the receipt of the Goods give SFL a written notice of any claim, that the Goods are not of stated description or specification to enable SFL to investigate and take appropriate action.
- 5.3 SFL will not be responsible for any shortage/damages notices after delivery has been taken by the Buyer and not reported on the back side of "Lorry Receipt" of Transporter.
- 5.4 The Buyer shall provide SFL with the appropriate tax forms/declarations along with payment and shall indemnify SFL against any losses, charges, expenses for non- submissions of the forms.
- 5.5 The Goods shall be dispatched at such times and in such convenient lots and quantities as SFL shall decide. SFL shall be entitled to cancel an order in whole or in part even if it has been partly executed. Each lot dispatched against a single order shall be considered as a separate contract and failure of dispatch of any one lot or of the balance lots shall not violate the contract as to other lots. The order shall be deemed to have been completed on the date of dispatch in respect of the products actually dispatched in part/full.
- 5.6 SFL shall not be responsible for delays in dispatch of the Goods for any reason whatsoever and the conditions of dispatch and delivery timing of the same. SFL shall not be liable to make good the loss, if any suffered by the Buyer for delay in dispatch or delivery of the Goods.
- 5.7 If the Buyer failed to take delivery of the Goods at the rate, date and time specified herein when the delivery becomes due, then SFL will have the option to cancel the delivery and to claim damages, if any.
- 5.8 Claims by Buyer for shortages or errors in delivery must be made within five (5) days after the delivery of the Goods. Goods are sold subject to the standard manufacturing practices of SFL. Goods purchased on the basis of weight are subject to customary quantity variations recognized by practice in the industry.
- 5.9 If Buyer requests deferral of deliveries, SFL's agreement to defer delivery shall not excuse Buyer from its obligation to pay for the Goods at the same times and in the same quantities as the original delivery schedule, including interest due pursuant to these terms and conditions. In addition to adhering to the original payment schedule, Buyer shall pay such storage charges as SFL may assess for storing the Goods awaiting delivery. If Buyer requests deferral prior to commencement of production, SFL may require progress payments in connection with expenses for materials and services incurred by SFL in anticipation of production.
- 5.10 In no case shall delay or non-delivery of the whole or part of the order be a valid ground for the Buyer to reject or withhold payment for the Goods.

6. WARRANTY

- 6.1 All Goods sold subject to the conditions that SFL's liabilities are limited to the replacement of Goods proved to have been defective in material and/or workmanship, when they are sent back to SFL, but SFL will not be responsible for failure of Goods supplied which have been subject to improper use and/or any process or processes.
- 6.2 SFL accepts no responsibility for any contingent or resulting liabilities or loss arising through any defective Goods.
- 6.3 Any claim for replacement will arise only if the Goods are returned within 30 days from the date of Supply.



- 6.4 All other warranties, express or implied, including but not limited to the implied warranties of merchantability and fitness for a particular purpose, are hereby disclaimed.
- 6.5 Any claims for failure of Goods to conform to specifications, shortages, or any other cause shall be deemed waived and released by Buyer unless such claim is made in writing within thirty (30) days from the date of receipt of Goods.
- 6.6 SFL's decision on the cause for any such defects is final and binding.
- 6.7 SFL will not be responsible for failure of Goods supplied which are manufactured to the print, design, technical specification of the Buyer or sample/prototype approved by Buyer and/or any process or processes prescribed by Buyer.
- 7. LIMITATION OF LIABILITY**
SFL's liability to Buyer, whether in contract, in tort, under any warranty, in negligence or otherwise, shall not exceed in any case the return of the amount of the purchase price paid by Buyer and under no circumstances SFL be liable for special, in direct or consequential damages. The price stated for the Goods is consideration for limiting SFL's liability. No action, regardless of form, arising out of the transactions under the invoice may be brought by Buyer more than one (1) year after the date of the invoice. Without limitation of the foregoing, in no event will SFL be responsible or liable for (a) penalties or penalty clauses of any description, or (b) indemnification of Buyer or others for costs, damages or expenses arising out of or related to the Goods.
- 8. INDEMNIFICATION**
Buyer shall save and hold SFL harmless from any claims, demands, liabilities, costs, expenses or judgments arising in whole or in part, directly or indirectly, out of breach of obligations, non-compliance any statute/act/rules, negligence, any act or omission, lack of care by Buyer or Buyer's customers, agents, employees or invitees involving the handling, use, possession or resale of the Goods supplied by SFL whether used alone or in combination with other Products. This indemnification shall include all costs, attorney's fees and other expenses paid or incurred by or imposed upon SFL in connection with the defense of any such claim.
- 9. FORCE MAJEURE**
SFL shall not be liable in any way for any damage, loss, cost or expense arising out of or in connection with any delay, restriction, interference or failure in performing any obligation towards supply or delivery of Goods caused by any circumstance beyond its reasonable control, including, without limitation, acts of God, laws and regulations, administrative measures, orders or decrees of any court, earthquake, flood, fire, explosion, war, terrorism, riot, sabotage, accident, epidemic, strike, lockout, slowdown, labour disturbances, geo-political events, business exigencies, difficulty in obtaining necessary labour or raw materials, lack of or failure of transportation, breakdown of plant or essential machinery, emergency repair or maintenance, breakdown or shortage of utilities, delay in delivery or defects in Goods supplied by suppliers or subcontractors ("Force Majeure"). Any failure in performing any obligations shall not entitle the Buyer to cancel the Order.
- 10. INTELLECTUAL PROPERTY RIGHTS**
- 10.1 The sale of Goods to Buyer shall not, by implication or otherwise, convey any license or intellectual property right relating to the Goods to Buyer.
- 10.2 When Goods are manufactured to Buyer's drawings and/or specifications, the responsibility to ensure that these do not result in infringement of any patent or trademark will lie entirely with the Buyer concerned and the Buyer will be solely responsible for the consequence in case of any such infringement.
- 10.3 SFL owns and retains all right, title and interest in and to any patents, copyrights, mask works, trade secrets, trademarks and other intellectual property rights in and to the Goods. The Buyer is not permitted to use any SFL's trademark, logo or trade name in its letter head, business cards, printed materials, business communication letters or in connection with any Goods, other than with respect to resale of Goods pre-marked or packaged by or on behalf of SFL without prior written consent of SFL.
- 10.4 SFL shall not be liable for any loss or damage for infringement of Intellectual Property Rights.
- 11. CONFIDENTIALITY**
All information disclosed by SFL which is either expressly identified as confidential or by its nature is implicitly confidential will be kept in strict confidence by the Buyer and not used by the Buyer.
- 12. APPLICABLE LAW, JURISDICTION & ARBITRATION**
- 12.1 Any dispute which may arise from and for any Goods supplied to Buyer shall be governed by the Indian laws and subject to the exclusive jurisdiction of the Courts at Chennai.
- 12.2 Any dispute in connection with or arising between the parties fail to amicably resolve shall be referred to arbitration of a sole arbitrator to be appointed jointly by the parties in accordance with the Indian Arbitration and Conciliation Act, 1996 or statutory modification or enactment thereof. The award of the arbitrator shall be final and binding on the Parties. The place of arbitration shall be Chennai, India, and the language of arbitration proceedings shall be English. Each party irrevocably and unconditionally submits to the jurisdiction of the Courts in Chennai, India, alone to determine any question that may arise other than a matter as provided for hereinabove.
- 13. MISCELLANEOUS**
- 13.1 All notices or documents addressed to the Buyer shall be deemed to have been validly served if delivered at/or sent by post to their last known address. SFL will not be responsible for any demurrage etc., on consignment due to public holidays, postal delays, etc. or any other reasons beyond SFL's control.
- 13.2 In case the Buyer fails to make payment on or before Due Date, the Buyer shall be fully responsible for all the consequential losses to SFL including loss of Goods, interest, freight, taxes, duties and any other charges required to be borne by SFL.
- 13.3 If the Buyer fails to make the payment when it becomes due or if there is any breach by the Buyer of any terms and conditions, SFL may without prejudice to the other rights or remedies cancel this order forthwith or refuse to make further deliveries; in which SFL shall not be held responsible in anyway.
- 13.4 SFL shall have lien on the Goods delivered/supplied to the Buyer as to the unpaid purchase price of Goods (whether in possession or not in possession) and SFL shall be entitled to exercise the lien to recover the unpaid purchase price by taking back the Goods and shall be entitled to sell the same to any other Buyer and adjust the sum so realised against the unpaid purchase price without prejudice to SFL's other rights and remedies to recover the outstanding dues and/or other dues.
- 13.5 SFL reserves its right to appropriate and adjust any sums due to the Buyer against any dues recoverable from the Buyer including delayed payment charges, if any.
- 13.6 The rights and liabilities are not assignable by Buyer in whole or part without prior written consent of SFL.
- 13.7 Any provision hereof prohibited by law shall be ineffective to the extent of such prohibition and without invalidating the remaining provision hereof.
- 13.8 No waiver by SFL of a breach of any provision hereof shall constitute a waiver of any other breach of such provision or any other provision.
- 13.9 Buyer shall be responsible for compliances of law as applicable.
- 13.10 The price mentioned in the Invoice supersedes the list circulated and all the previous price lists and any other price communication.
- 13.11 The prices are for Zinc phosphate, Green Finish (5-8microns). Trivalent Finish 2500,2600 (Chrome free). Others would be charged @ 10% Extra or as mutually agreed.
- 13.12 The Buyer will adhere to the minimum ordering quantities, i.e. standard packing.
- 13.13 Revision in price if any will be intimated from time to time in the form of Sales Bulletins.

Please quote correct SFL Part Number and Description of items while ordering. For any grievance, claim or clarification please write to - vasudevan.r2@sfl.co.in (Email-ID) and also contact the SFL's Marketing Dept.



OUR DISTRIBUTORS AND THEIR BRANCHES

DISTRIBUTORS	Branches at:
<p>India Motor Parts & Accessories Ltd. 'SUNDARAM TOWERS' 45&46, Whites Road, Chennai - 600 014. Tel. : +91-44-28523996 / 28524097 Fax : +91-44-28523009</p>	<p>Agra, Agartala, Ahmedabad, Asansol, Aurangabad, Bangalore, Baroda, Bhubaneswar, Bhilwara, Chandigarh, Chennai, Coimbatore, Cuttack, Dankuni, Dhanbad, Erode, Ernakulam, Gandhidham, Guwahati, Hissar, Hubli, Hyderabad, Indore, Jaipur, Jammu, Jodhpur, Jalandhar, Jamshedpur, Kanpur, Kolkata, Kozhikode, Kota, Kolhapur, Kottayam, Kadapa, Karimnagar, Kumbakonam, Kurnool, Ludhiana, Lucknow, Madurai, Mangalore, Morigate (Delhi), Muzaffarpur, Mysuru, Nagpur, New Mumbai, Nanded, Patna, Pune, Purnea, Rajkot, Ranchi, Raipur, Redhills, Sambalpur, Salem, Shimoga, Silchar, Silliguri, Surat, Tirunelveli, Trichy, Trivandram, Thrissur, Udaipur, Varanasi, Vellore, Vijayapura, Vijayawada, Visakhapatnam.</p>
<p>Jullundur Motor Agency (Delhi) Ltd. 458-1/16, Sohna Road, Opp. New Court Gurgaon - 122 001. Tel. : +91-124-3099001/02/03 Fax : +91-124-5083079</p>	<p>Agra, Allahabad, Alwar, Amritsar, Asansol, Alampur, Baddi, Bathinda, Bhilwara, Bhubaneswar, Bikaner, Chandigarh, Cuttack, Dehradun, Ghaziabad, Gorakhpur, Gurgaon, Guwahati, Haldwani, Indore, Jabalpur, Jaipur, Jammu, Jamshedpur, Jodhpur, Jalandhar, Kanpur, Kashmir Gate (Delhi), Kolkata, Kota, Lucknow, Ludhiana, Muzaffarpur, Ranchi, Patiala, Pathankot, Patna, Raipur, Rourkela, Saharanpur, Siliguri, Tinsukia, Udaipur, Varanasi.</p>
<p>JMA Marketing Limited 2E/5 Jhandewalan Extension, New Delhi 110 055. Tel. : +91-11-23532985/41501425</p>	<p>Ahmedabad, Aurangabad, Baroda, Bhiwandi, Chakan, Kolhapur, Latur, Mumbai, Nagpur, Nasik, Pune, Rajkot, Surat, Solapur, Turbhe (Navi Mumbai), Nigdi.</p>
<p>Madras Auto Service Post Box No. 707, 180, Annasalai Chennai - 600 006. Tel. : +91-44-28523793 / 28523795 Fax : +91-44-28522003</p>	<p>Adimali, Allahabad, Ahmednagar, Aurangabad, Bangalore, Hissar, Hosakote (Bangalore) Belagavi, Ballari, Bikaner, Bhopal, Cuddalore, Chandigarh, Chennai, Delhi, Coimbatore, Ernakulam, Erode, Margoa-Goa, Gorakhpur, Hubli, Hyderabad, Haldwani, Hissar, Indore, Jaipur, Jodhpur, Jammu, Jabalpur, Kanpur, Kannur, Kottayam, Kolhapur, Kurnool, Kukatpally, Kozhikode, Kumbakonam, Latur, Ludhiana, Lucknow, Mangalore, Madurai, Mysuru, Nagpur, Namakkal, Nellore, New Mumbai, Pune, Raipur, Rajahmundry, Redhills, Salem, Sikar, Shimoga, Tambaram, Trichy, Thrissur, Tirupathi, Tirunelveli, Trivandrum, Udaipur, Urapakkam, Varanasi, Vellore, Vijayawada, Visakhapatnam, Warangal.</p>
<p>Partap Singh & Sons 516/517, Parekh Market, JSS Road., Opera House, Mumbai - 400 004. Tel. : +91-22-43005002 Fax : +91-22-43005003</p>	<p>Agra, Ahmedabad, Ahmednagar, Aurangabad, Baroda, Bikaner, Bhiwandi, Bhopal, Chandigarh, Dehradun, Chakan, Morigate (Delhi), Dhulia, Ponda - Goa, Gurgaon, Gandhidham, Indore, Kalamboli, Jaipur, Jammu, Jodhpur, Jabalpur, Jalandhar, Jasai, Kanpur, Kolhapur-City, Latur, Mumbai, Nagdevi, Nagpur, Nanded, Nasik, New Mumbai, Nigdi, Neemuch, Parwanoo, Pune, Raipur, Rajkot, Sangli, Kolhapur-Shiroli, Solapur, Surat, Turbhe, Ulhasnagar, Vadodara, Vapi, Varanasi, Wadala.</p>
<p>Sundaram Motors 180, Annasalai, Chennai - 600 006. Tel. : +91-44-28524031 / 28522230 Fax : +91-44-28555717</p>	<p>Bangalore, Ballari, Belagavi, Bolangir, Bardhaman, Berhampur, Chennai, Cuttack, Guntur, Davanagere, Ponda - Goa, Auto Nagar (Hyderabad), Hubli, Kalaburagi, Karimnagar, Kadapa, Kolkata, Kolhapur, Mangalore, Mysuru, Malda, Muzaffarpur, Nagpur, Nasik, Nellore, New Mumbai, Poonamallee, Pune, Patna, Ranchi, Rajahmundry, Rourkela, Secunderabad, Shimoga, Siliguri, Silchar, Solapur, Vellore, Vijayawada, Vijayapura, Visakhapatnam, Yeshwantpur.</p>
<p>The Associated Auto Parts Pvt. Ltd. 445 Dr. Bhadkamkar Marg (Lamington Road), Mumbai 400 004. Tel. : +91-22-23822354, 23822355</p>	<p>Ahmedabad, Ahmednagar, Aurangabad, Baroda, Gandhidham, Indore, Jabalpur, Jalgaon, Kolhapur, Navi Mumbai, Nasik, Nanded, Nagpur, Katraj-Pune, Rajkot, Raipur, Surat, Sangli, Solapur, Chimbli Phata (Pune).</p>
<p>TV Sundram Iyengar & Sons Pvt. Ltd. OESL Division, 180, Annasalai, Chennai 600 006 Tel.: +91-44-28579258</p>	<p>Bhopal, Cochin, Coimbatore, Dindigul, Jabalpur, Haldwani, Indore, Kanpur, Tirunelveli, Trichy, Pudukottai, Salem, Namakkal, Nagercoil, Madurai, Pondichery, Pollachi, Erode, Dharmapuri, Tirupur, Jaipur, Jodhpur, Kozhikode, Thiruvananthapuram, Kollam, Kottayam, Thrissur, Kannur, Mallapuram, Villupuram, Varanasi</p>
<p>Lucas Indian Service Limited 28, Poomagal Main Road Behind Olympia Park, Ekkattuthangal, Guindy, Chennai- 600032 Tel: +91-44-22255032 Extn 611</p>	<p>Bhubaneswar, Guwahati, Kolkata, Patna, Ranchi, Siliguri.</p>
<p>CAPL Motor Parts Private Limited Plot No. 8B, Survey No. 533/ 1A & 1B & 533/2 Maharaja Estate, Behind Anand Hotel Sarkhej J-Sanand Road, Sarkhej Ahmedabad - 382210</p>	<p>Ahmedabad</p>



Sundram Fasteners Limited

98A, Dr.Radhakrishnan Salai,
7th Floor, Auras Corporate Centre,
Mylapore, Chennai 600 004
Ph : 044-28478500

1st September 2021

Dear Customer,

Our price list number **SF/SOCKET/02/2021**, based on standard category **effective 1st September 2021** is given in this booklet.

While care is taken to ensure correctness of this price list, we would be pleased if you could communicate your suggestions and improvements of the same.

We are proceeding with limited print hence physical circulation will be restricted with limited copies, while e-price list will be made available.

We welcome your suggestions to upgrade the content of this price list and request you to send in the same to vasudevan.r2@sfl.co.in

Finally, we reserve the right to change any part of this price list without prior notice.

Thanking you and assuring you of our best attention always.

Yours truly,

R.Vasudevan

Deputy General Manager - Marketing



INDEX

Sl.No.	Description	Page No.
1	Socket Products Technical Data Sheet & Suggested Hex Keys	9-10
METRIC SERIES		
2	Socket Head Cap Screws - (M3-M12)	11
3	Socket Head Cap Screws - (M14-M24)	12
4	Socket Set Screws - Knurled Cup Point (M3-M12)	13
5	Socket Set Screws - Flat, Cone, Dog, Plain Cup Point (M4-M12)	14
6	Socket Countersunk Head Cap Screw - (M3-M20)	15
7	Socket Button Head Cap Screw - (M3-M10)	16
8	Low Head Socket Head Cap Screw - (M4-M16)	17
9	Socket Head Cap Screw / Bolts (M16-24 Above 200mm length) (M27-M42)	18
INCH SERIES		
10	Socket Head Cap Screws - BSW - (3/16" - 7/16")	19
11	Socket Head Cap Screws - BSW - (1/2" - 1")	20
12	Socket Head Cap Screws - BSF/UNF - (3/16" - 7/16")	21
13	Socket Head Cap Screws - BSF/UNF - (1/2" - 1")	22
14	Socket Head Cap Screws - UNC - (3/16" - 7/16")	23
15	Socket Head Cap Screws - UNC - (1/2" - 1")	24
16	Socket Set Screws - Knurled Cup Point - BSW	25
17	Socket Countersunk Head Cap Screw - BSW - (1/4" - 5/8")	26
18	Socket Countersunk Head Cap Screw - UNC - (1/4" - 5/8")	27
19	Socket Countersunk Head Cap Screw - BSF/UNF	28
SHB / SHS - Grade 8.8		
20	Socket Head Cap Screws - (M3-M12)	29
21	Socket Head Cap Screws - (M14-M24)	30
22	Socket Head Cap Screw / Bolts (M16-24 Above 200mm length) (M27-M36)	31
23	Socket Button Head Cap Screw - (M3-M10)	32
24	Socket Countersunk Head Cap Screw - (M3-M20)	33
25	Low Head Socket Head Cap Screw - (M4-M16)	34
SOCKET KEYS		
26	Socket Keys - Metric Series	35-36
27	Socket Keys T Handle Hex (long)	37
28	Socket Keys - Inch Series	38-39



Socket Products

Technical Data Sheet

Socket Countersunk Head Screws

BS Inch Series

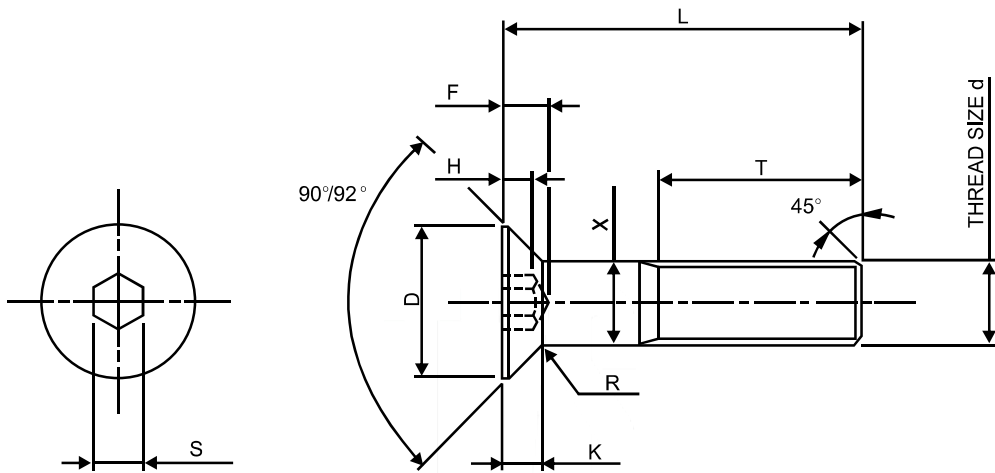

D-MAX THEORETICAL SHARP CORNERS

D-MAX THEORETICAL SHARP CORNERS

THREAD SIZE Ø	D	X	F	K	H	R	T	S
	Max	Max	Max	Ref	Min	Ref	Min	Nom
3/16	0.356	0.187	0.097	0.085	0.065	0.025	1.000	3/32
1/4	0.475	0.250	0.132	0.113	0.085	0.025	1.000	5/32
5/16	0.596	0.312	0.159	0.142	0.105	0.025	1.125	3/16
3/8	0.712	0.375	0.187	0.169	0.125	0.025	1.250	7/32
7/16	0.833	0.437	0.211	0.198	0.142	0.025	1.375	1/4
1/2	0.951	0.500	0.248	0.226	0.165	0.025	1.500	5/16
5/8	1.190	0.625	0.318	0.283	0.220	0.025	1.750	3/8

(All dimensions in inches)

- 1. Material : Special grade alloy steel
- 2. Hardness : 36 to 45 HRc
- 3. Thread fit : Medium Class as per BS:84



Suggested Hexagon Keys

METRIC SERIES

Sl.No	Diameter	SHCS	SHCB	CSK	BUTTON	SSS	LHCS
1	M3	2.5	2.5	2	2	1.5	
2	M4	3	3	2.5	2.5	2	2.5
3	M5	4	4	3	3	2.5	3
4	M6	5	5	4	4	3	4
5	M8	6	6	5	5	4	5
6	M10	8	8	6	6	5	7
7	M12	10	10	8	8	6	8
8	M14	12	12				10
9	M16	14	14	10	10		12
10	(M18)	14	14				12
11	M20	17	17	12			14
12	(M22)	17	17				
13	M24	19	19				
14	M27	19	19				
15	M30	22	22				
16	M33	24	24				
17	M36	27	27				

INCH SERIES

Sl.No	Diameter	SHCS	SHCB	CSK	SSS	
					BSF/BSW	UNF/UNC
1	3/16	5/32	5/32		3/32	
2	1/4	3/16	3/16	5/32	1/8	1/8
3	5/16	7/32	7/32	3/16	5/32	5/32
4	3/8	5/16	5/16	7/32	3/16	3/16
5	7/16	5/16	5/16			
6	1/2	3/8	3/8	5/16	1/4	1/4
7	5/8	1/2	1/2	5/16		
8	3/4	9/16	9/16			
9	7/8	9/16	9/16			
10	1	5/8	5/8			



Socket Head Cap Screws

Metric Series M3 - M12

Recommended Retail Prices in Rupees Per 100 Pieces



- 1. Specification : Generally conforming to IS:2269, DIN 912, ISO:4762
- 2. Threads : 12.9 Grade 5g6g as per ISO 261, ISO 965-2; ISO 965-3
- 3. Material : Special grade alloy steel
: 10.9 Low Carbon boron steel, Medium carbon steel, Medium carbon boron steel, Special alloy steel
- 4. Mechanical Properties : 10.9, 12.9 As per ISO 898-1
- 5. Note : Sizes in brackets are non-preferred standards. Shaded sizes are fully threaded.
- 6. Finish : Thermal/ Chemical Blackened with rust preventive oil (Black colour)

Diameter	M3	M4	M5	M6	M8	M10	M12
Length	Key	Key	Key	Key	Key	Key	Key
(mm)	2.5mm	3mm	4mm	5mm	6mm	8mm	10mm
5	1400	1225	-	-	-	-	-
6	1205	1225	1420	1475	-	-	-
8	895	920	985	1015	1240	-	-
10	750	730	560	585	1130	1290	-
12	750	665	565	685	865	1290	-
(14)	780	695	635	650	755	1190	-
16	780	565	635	650	755	1190	3510
(18)	780	745	690	685	795	1090	3130
20	780	600	590	685	795	1090	3130
(22)	805	770	725	755	885	1195	2725
25	805	620	725	755	885	1195	2725
30	945	905	835	855	960	1315	2725
35		995	920	935	1050	1415	2795
40		1090	995	*1010	1130	1510	2810
45		1245	1080	*1090	*1215	1630	2860
50		1540	1165	*1165	*1260	*1740	2925
55		2455	1980	*1260	*1385	*1880	*3085
60			2540	2325	*1490	*2025	*3260
65			5040	2405	1590	2185	*3435
70			6035	2500	1700	2350	*3620
75				2790	1795	2495	*3780
80				3170	2700	3855	*4525
85				3220	3120	4385	*5115
90				3220	3120	4385	*5115
95				3635	3705	5160	*5920
100				3635	3705	5160	*5920
105				4350	4625	6085	*7100
110				4350	4625	6085	7100
115				5705	5395	6160	8175
120				5705	5395	6160	8175
125				6890	6630	8475	9930
130				6890	6630	8475	9930
135				7420	7125	9475	11060
140				7420	7125	9475	11060
145					7695	10525	12200
150					7695	10525	12200
155							20105
160							20105
165							22115
170							22115
175							22115
180							22115
185							23930
190							23930
195							23930
200							23930



Socket Head Cap Screws

Metric Series M14 - M24

Recommended Retail Prices in Rupees Per 100 Pieces



1. Specification : Generally conforming to IS:2269, DIN 912, ISO:4762
2. Threads : 12.9 Grade 5g6g as per ISO 261, ISO 965-2; ISO 965-3
3. Material : Special grade alloy steel
10.9 Low Carbon boron steel, Medium carbon steel, Medium carbon boron steel, Special alloy steel
4. Mechanical Properties : 10.9, 12.9 As per ISO 898-1
5. Note : Sizes in brackets are non-preferred standards. Shaded sizes are fully threaded.
6. Finish : Thermal/ Chemical Blackened with rust preventive oil (Black colour)

Diameter	M14	M16	M18	M20	M22	M24
Length	Key	Key	Key	Key	Key	Key
(mm)	12mm	14mm	14mm	17mm	17mm	19mm
5						
6						
8						
10						
12						
(14)						
16		8900				
(18)						
20	7855	6900				
(22)	7080	6900				
25	7080	6900		16840		
30	7080	6900	18525	16840		
35	5955	5800	18765	17060		
40	6095	5940	16425	14940		18010
45	6200	6045	16540	15045		18475
50	6350	6175	16680	15160	19380	17695
55	6425	6270	16785	15255	21785	19905
60	6815	*6630	16910	15365	22400	20460
65	6910	*6730	17060	15505	24945	22780
70	7455	7260	18220	16560	24205	23205
75	7875	7685	19400	*17640	28320	24590
80	8255	8035	19780	*17985	28320	25850
85	8440	8215	20175	18345	29695	27115
90	8440	8215	20175	18345	29695	27115
95	10460	10195	21155	19235	31320	28595
100	10460	10195	21155	19235	31320	28595
105	11375	11075	23415	21275	34045	31095
110	11375	11075	23415	21275	34045	31095
115	12290	11970	25645	23330	36800	33610
120	12290	11970	25645	23330	36800	33610
125	14235	13860	27900	25370	48380	36120
130	14235	13860	27900	25370	48380	36120
135	15235	14835	30130	27390	56530	38620
140	15235	14835	30130	27390	56530	38620
145	16240	15810	32365	29430	75360	41140
150	16240	15810	32365	29430	75360	41140
155	18240	31460	39505	37720	107780	66785
160	19145	31460	39505	37720	107780	66785
165		35030	45130	43070	115300	71455
170		35030	45130	43070	115300	71455
175		35030	45130	43070	115300	71455
180		35030	45130	43070	115300	71455
185		38715	47055	44915	123430	76490
190		38715	47055	44915	123430	76490
195		38715	47055	44915	123430	76490
200		38715	47055	44915	123430	76490



Socket Set Screws

Metric Series M3 - M12

Knurled Cup Point

Recommended Retail Prices in Rupees Per 100 Pieces



Diameter Length (mm)	M3	M4	M5	M6	M8	M10	M12
3	400						
4	375	375					
5	380	380	265	440			
6	385	385	265	265	295		
8	390	390	265	295	295	335	
10	410	335	295	240	300	335	890
12	440	440	305	310	310	375	640
16	455	455	310	335	350	420	695
20				355	375	455	730
25				430	430	540	830
30				585	610	780	960
35					710	900	1095
40							
45							
50							
55							
60							
65							
70							

- | | |
|--------------------------|---|
| 1. Specification | : Generally conforming to ISO 4029 (Without Knurling details) |
| 2. Threads | : 12.9 Grade 5g6g as per ISO 261, ISO 965-2; ISO 965-3 |
| 3. Material | : Special grade alloy steel |
| 4. Mechanical Properties | : Property class 45H as per ISO 898-5 |
| 5. Finish | : Thermal/ Chemical Blackened with rust preventive oil (Black colour) |





Socket Set Screws

Metric Series M4 - M12
Flat Point, Cone Point, Dog Point, Plain Cup Point
Recommended Retail Prices in Rupees Per 100 Pieces

Diameter Length (mm)	M4	M5	M6	M8	M10	M12
4		380				
5		380	625			
6	545	380	385			
8	560	385	410	410	470	
10	590	410	430	430	470	910
12	620	435	440	445	525	910
16	650	445	475	490	600	990
20			505	535	645	1040
25			610	610	775	1190
30			820	870	1120	1365
35				1010	1290	1570

1. Specification : Generally conforming to IS:6094, ISO:4026, ISO 4027, ISO 4028, ISO 4029
 2. Threads : 5g6g as per ISO 261, ISO 965-2, ISO 965-3
 3. Material : Special grade alloy steel
 4. Mechanical Properties : Property class 45H; as per ISO 898-5

 FLAT
6094
913

 CONE
6094
914

 DOG
6094
915

 PLAIN CUP
6094
916

5. Finish : Thermal/ Chemical Blackened with rust preventive oil (Black colour)



Socket Countersunk Head Cap Screws

Metric Series M3 - M20

Recommended Retail Prices in Rupees Per 100 Pieces



Diameter	M3	M4	M5	M6	M8	M10	M12	M16	M20
Length (mm)	Key 2mm	Key 2.5mm	Key 3mm	Key 4mm	Key 5mm	Key 6mm	Key 8mm	Key 10mm	Key 17mm
6	1165								
8	1165	640	930	1115					
10	1245	640	520	715					
12	1335	540	540	580	930				
16	1515	725	725	725	930	1505			
20	1695	780	780	780	995	1240			
25	1865	910	910	910	1145	1430	2610		
30		1095	1095	1095	1305	1635	2975	5075	
35		2260	1455	1455	1485	1875	3345	5470	
40		2425	2260	1455	1695	2145	3720	5845	6260
45		2745	2575	2575	2575	2425	4085	6245	7340
50		3220	3220	3220	2960	2720	4455	6640	7340
55					3535	3085	4830	7010	7000
60					3960	3415	5205	7410	8425
65							5860	8150	8970
70							6310	8565	9505
75							6785	8990	10595
80							7305	9440	10595
85							7850	10705	11685
90							8455	10705	11685
95							9095	12945	14000
100							9790	12945	15000
110								17200	18000
120							13105	20645	22000
130								22935	24000

- | | | | |
|----|-----------------------|---|---|
| 1. | Specification | : | Generally conforming to ISO 10642, IS:6761, DIN 7991 |
| 2. | Threads | : | 12.9 Grade 5g6g as per ISO 261, ISO 965-2; ISO 965-3 |
| 3. | Material | : | Special grade alloy steel |
| 4. | Mechanical Properties | : | Property class 12.9 as per IS:1367-3, ISO 898-1 |
| 5. | Note | : | All sizes are fully threaded. |
| 6. | Finish | : | Thermal/ Chemical Blackened with rust preventive oil (Black colour) |



Socket Button Head Cap Screws

Metric Series M3 - M10

Recommended Retail Prices in Rupees Per 100 Piece



Diameter	M3	M4	M5	M6	M8	M10
Length	Key	Key	Key	Key	Key	Key
(mm)	2mm	2.5mm	3mm	4mm	5mm	6mm
6	1030	665	1075			
8	1220	665	1025	1155		
10	1315	665	710	795	1270	
12	1410	710	740	635	1025	
16	1590	765	800	850	870	1655
20	1760	815	850	920	1095	1360
25	1935	955	995	1070	1255	1570
30		1150	1200	1230	1440	1795
35			1370	1395	1625	2055
40			1530	1600	1850	2360
45				1945	2135	2745
50					2355	3030
60					3355	

- | | | |
|----|-----------------------|---|
| 1. | Specification | : Generally conforming to ISO :7380-1 |
| 2. | Threads | : 5g6g as per ISO 261; ISO 965-2;ISO 965-3 |
| 3. | Material | : Special grade alloy steel |
| 4. | Mechanical Properties | : Property class 12.9 as per ISO 898-1 |
| 5. | Note | : All sizes are fully threaded. |
| 6. | Finish | : Thermal/ Chemical Blackened with rust preventive oil (Black colour) |



Low Head Socket Head Cap Screws

Metric Series M4 - M16

Recommended Retail Prices in Rupees Per 100 Piece

Diameter Length (MM)	M4	M5	M6	M8	M10	M12	(M14)	(M16)
5								
6	1470							
8	1110	1135	1135					
10	880	785	765	1270				
12	795	795	765	970				
(14)	835	730	725	850				
16	835	730	725	850	1335			
(18)	890	785	765	880	1220			
20	890	785	765	880	1220	3280		
(22)	920	840	850	985	1340	2855		
25	920	840	850	985	1340	2855	7430	
30		970	955	1080	1470	2855	7430	5710
35			1045	1175	1595	2920	6250	6080
40				1270	1700	2940	6390	6080
45						3000	6505	6145
50						3060	6650	6460

1. Specification : Generally conforming to DIN 7984
2. Material : 10.9 Grade Low Carbon boron Steel, Medium Carbon Steel.
Medium carbon Boron Steel, Special Alloy steel
3. Mechanical Properties : As per DIN EN ISO 898-1
4. Tensile Load requirement : 80% of the values specified in DIN EN ISO 898-1
5. Note : Sizes in brackets are non-preferred standards.
6. Plating Finish : Thermal/Chemical Blackend with rust preventive Oil(Black Colour)



Socket Head Cap Screws/Bolts

Metric Series M16-M24 *(Above 200mm length)*

Metric Series M27-M42

Recommended Retail Prices in Rupees Per 100 Piece



Diameter	(M16)	(M20)	(M22)	(M24)	(M27)	M30	(M33)	M36	M42
Length	Key	Key	Key	Key	Key	Key	Key	Key	Key
(mm)	14mm	17mm	17mm	19mm	19mm	22mm	24mm	27mm	32mm
45						48205			
50						48205			
55						48205			
60						42240			
65						42240			
70					43910	42240			
(75)					43910	42240	63475		
80					43910	43910	66095	78980	
90					48205	48205	71580	86125	
100					51535	51535	74925	88515	
110					54645	54645	78980	93525	
120					57980	57980	86125	97345	
130					58545	62040	90185	100675	
140					64420	64420	95910	111170	218055
150					68480	68480	100675	115235	240770
160					107840	107840	133830	155540	286320
(170)					119285	119285	148145	173190	286320
180					119285	119285	148145	173190	303880
(190)					129780	129780	161025	187745	303880
200					129780	129780	161025	187745	329220
(210)	40495	47685	129535	79170	161745	161025	199665	232105	329220
220	40495	50470	135625	81855	161745	161025	199665	232105	413020
(230)	42285	62070	141010	85110	179150	173190	215170	238545	430510
240	42285	80725	146400	88355	179150	173190	215170	238545	430510
(250)	44065	89195	151775	90240	204740	185355	224945	255485	459190
260	44065	97650	157155	76265	195140	185355	224945	255485	459190
(270)	45850	106665	162530	94210	208245	197520	237350	272410	487890
280	45850	115670	167915	96895	208245	197520	237350	272410	487890
(290)	47645	119810	173915	100515	221365	209680	255950	289345	516595
300	47645	123935	179910	104150	221365	209680	255950	289345	516595

- | | | |
|--------------------------|---|--|
| 1. Specification | : | Generally conforming to IS:2269, ISO:4762, DIN 912 |
| 2. Threads | : | ISO Metric, 5g6g for 12.9; 10.9 as per ISO 261, ISO 965-2, ISO 965-3 |
| 3. Material | : | 12.9 - Special grade alloy steel |
| 4. Mechanical Properties | : | 10.9 Low Carbon boron steel, Medium carbon steel, Medium carbon boron steel, Special alloy steel |
| 5. Note | : | Property class as per ISO 898-1 |
| 6. Finish | : | Sizes in brackets are non-preferred standards. |
| | : | 12.9 Grade - Thermal/ Chemical Blackened with rust preventive oil (Black colour) |



Socket Head Cap Screws

Inch Series BSW (3/16" - 7/16")



Recommended Retail Prices in Rupees Per 100 Piece

Diameter	Screws		Bolt			
	3/16"	1/4"	1/4"	5/16"	3/8"	7/16"
Length	Key	Key	Key	Key	Key	Key
(mm)	5/32"	3/16"	3/16"	7/32"	5/16"	5/16"
3/8	790	715	760	970		
1/2	790	715	760	960	1555	
5/8	740	685	730	850	1555	
3/4	790	715	760	880	1265	3760
7/8	845	755	805	925	1405	3760
1	870	800	850	990	1405	3290
1-1/4	960	900	955	1075	1545	3290
1-1/2	1100	1000	1060	1190	1715	3350
1-3/4	1315	1225	1300	1425	2045	3585
2		1225	1300	1425	2045	3585
2-1/4		2450	2600	1695	2440	4115
2-1/2		2450	2600	1695	2440	4115
2-3/4		2640	2800	2005	2930	4635
3		2835	3010	2005	2930	4635
3-1/4		3395	3600	3500	4480	6290
3-1/2		3395	3600	3500	4480	6290
4		3740	3965	4140	5265	7285
4-1/2				6475	7735	9140
5				8065	9570	11205
5-1/2				9970	11505	12775
6				9970	11830	12775
6-1/2						
7						
7-1/2						
8						
8-1/2						
9						
10						

- | | | | |
|----|-----------------------|---|---|
| 1. | Specification | : | Generally conforming to BS:2470 |
| 2. | Threads | : | BS Fine, Medium fit as per BS:84, UNF, Class 2A as per BS 1580 |
| 3. | Material | : | Special grade alloy steel |
| 4. | Mechanical Properties | : | As per BS:2470 |
| 5. | Note | : | Shaded sizes are fully threaded. |
| 6. | Finish | : | Thermal/ Chemical Blackened with rust preventive oil (Black colour) |



Socket Head Cap Screws

Inch Series BSW (1/2" - 1")

Recommended Retail Prices in Rupees Per 100 Piece



Diameter	1 / 2"	5 / 8"	3 / 4"	7 / 8"	1"
Length	Key	Key	Key	Key	Key
(mm)	3 / 8"	1 / 2"	9 / 16"	9 / 16"	5 / 8"
3/8					
1/2	3505				
5/8					
3/4	3505	8445			
7/8	3505	7200			
1	3055	7200	18835		
1-1/4	3055	6265	18835		
1-1/2	3120	6485	16585	24935	23800
1-3/4	3315	6905	16980	25875	24695
2	3315	6905	16980	25875	24695
2-1/4	3825	7490	17345	27900	26650
2-1/2	3825	7490	17345	27900	26650
2-3/4	4310	8235	19735	31425	29995
3	4310	8235	19735	31425	29995
3-1/4	5850	8805	20520	34655	33085
3-1/2	5850	8805	20520	34655	33085
4	6770	11395	21510	36560	34885
4-1/2	8495	12090	26095	42955	41005
5	10420	13680	28380	46160	44075
5-1/2	11490	16960	30645	49390	47140
6	11885	17685	32920	52605	50210
6-1/2		37215	43185	88175	84165
7		39180	44175	91635	87180
7-1/2		40770	45200	94605	90310
8		43300	46065	97775	93320
8-1/2			48570		95995
9			52180		102060
10					

- | | | | |
|----|-----------------------|---|---|
| 1. | Specification | : | Generally conforming to BS:2470 |
| 2. | Threads | : | BS Fine, Medium fit as per BS:84, UNF ,Class 2A as per BS 1580 |
| 3. | Material | : | Special grade alloy steel |
| 4. | Mechanical Properties | : | As per BS:2470 |
| 5. | Note | : | Shaded sizes are fully threaded. |
| 6. | Finish | : | Thermal/ Chemical Blackened with rust preventive oil (Black colour) |



Socket Head Cap Screws Inch Series BSF/UNF (3/16" - 7/16")

Recommended Retail Prices in Rupees Per 100 Piece



Diameter	Screws		Bolt			
	3/16"	1/4"	1/4"	5/16"	3/8"	7/16"
Length	Key	Key	Key	Key	Key	Key
(mm)	5/32"	3/16"	3/16"	7/32"	5/16"	5/16"
3/8	960	880	935	1195		
1/2	960	880	935	1190	1915	
5/8	895	840	895	1045	1915	
3/4	960	880	935	1085	1550	4625
7/8	1040	925	985	1125	1735	4625
1	1080	985	1045	1210	1735	4040
1-1/4	1185	1105	1175	1315	1895	4040
1-1/2	1360	1225	1300	1465	2105	4120
1-3/4	1620	1520	1615	1735	2510	4395
2		1520	1615	1735	2510	4395
2-1/4		3005	3190	2075	2990	5065
2-1/2		3005	3190	2075	2990	5065
2-3/4		3240	3435	2480	3605	5710
3		3485	3695	2480	3605	5710
3-1/4		4180	4435	4300	5515	7740
3-1/2		4180	4435	4300	5515	7740
4		4590	4870	5090	6470	8945
4-1/2				7965	9515	11230
5				9910	11765	13780
5-1/2				11100	14140	15710
6				12260	14545	15710
6-1/2						
7						
7-1/2						
8						
8-1/2						
9						
10						

1.	Specification	:	Generally conforming to BS:2470
2.	Threads	:	BS Fine, Medium fit as per BS:84 UNF, class 2A as per BS: 1580
3.	Material	:	Special grade alloy steel
4.	Mechanical Properties	:	As per BS:2470
5.	Note	:	Shaded sizes are fully threaded.
6.	Finish	:	Thermal/ Chemical Blackened with rust preventive oil (Black colour)
7.	Pitch	:	for 3/16 Dia -Only BSW/BSF



Socket Head Cap Screws Inch Series BSF/UNF (1/2" - 1")

Recommended Retail Prices in Rupees Per 100 Piece



Diameter	1 / 2"	5 / 8"	3 / 4"	7 / 8"	1"
Length	Key	Key	Key	Key	Key
(mm)	3 / 8"	1 / 2"	9 / 16"	9 / 16"	5 / 8"
3/8					
1/2					
5/8					
3/4	4305				
7/8	4305	8870			
1	3750	8870	22110		
1-1/4	3750	7710	22110		
1-1/2	3830	7980	19475	29270	27950
1-3/4	4100	8490	19935	30460	29005
2	4100	8490	19935	30460	29005
2-1/4	4705	9215	20365	32765	31290
2-1/2	4705	9215	20365	32765	31290
2-3/4	5310	10125	23175	36895	35215
3	5310	10125	23175	36895	35215
3-1/4	7190	10830	24085	40685	38835
3-1/2	7195	10830	24085	40685	38835
4	8325	14010	25255	42930	40970
4-1/2	10440	14870	30640	50455	48150
5	12830	16840	33325	54205	51750
5-1/2	14125	20865	35980	57990	55365
6	14615	21760	38655	61760	58960
6-1/2		45770	50715	103545	98835
7		46230	51870	107600	102370
7-1/2		48205	53075	111110	106045
8		50145	54090	114820	109595
8-1/2		53265	57035		112735
9			61270		119855
10					

- | | | | |
|----|-----------------------|---|---|
| 1. | Specification | : | Generally conforming to BS:2470 |
| 2. | Threads | : | BS Fine, Medium fit as per BS:84 UNF, class 2A as per BS: 1580 |
| 3. | Material | : | Special grade alloy steel |
| 4. | Mechanical Properties | : | As per BS:2470 |
| 5. | Note | : | Shaded sizes are fully threaded. |
| 6. | Finish | : | Thermal/ Chemical Blackened with rust preventive oil (Black colour) |



Socket Head Cap Screws Inch Series UNC (3/16" - 7/16")

Recommended Retail Prices in Rupees Per 100 Piece



	Screws		Bolt			
Diameter	3/16"	1/4"	1/4"	5/16"	3/8"	7/16"
Length	Key	Key	Key	Key	Key	Key
(mm)	5/32"	3/16"	3/16"	7/32"	5/16"	5/16"
3/8	950	865	920	1175		
1/2	950	865	920	1165	1875	
5/8	890	820	870	1015	1875	
3/4	950	865	920	1060	1525	4545
7/8	1005	915	970	1110	1705	4545
1	1055	955	1015	1190	1705	3965
1-1/4	1165	1080	1145	1300	1850	3965
1-1/2	1320	1205	1280	1440	2075	4045
1-3/4	1585	1490	1580	1705	2450	4315
2		1490	1580	1705	2450	4315
2-1/4		2950	3130	2045	2940	4965
2-1/2		2950	3130	2045	2940	4965
2-3/4		3190	3385	2420	3540	5600
3		3415	3620	2420	3540	5600
3-1/4		4095	4345	4210	5405	7605
3-1/2		4095	4345	4210	5405	7605
4		4495	4765	5000	6340	8780
4-1/2				7820	9335	11015
5				9735	11545	13530
5-1/2					13875	15415
6					14280	15825
6-1/2						
7						
7-1/2						
8						
8-1/2						
9						
10						

- | | | | |
|----|-----------------------|---|---|
| 1. | Specification | : | Generally conforming to BS:2470 |
| 2. | Threads | : | UNC 2A as per BS:1580 |
| 3. | Material | : | Special grade alloy steel |
| 4. | Mechanical Properties | : | As per BS:2470 |
| 5. | Note | : | Shaded sizes are fully threaded. |
| 6. | Finish | : | Thermal/ Chemical Blackened with rust preventive oil (Black colour) |



Socket Head Cap Screws

Inch Series UNC (1/2" - 1")

Recommended Retail Prices in Rupees Per 100 Piece



Diameter	1 / 2"	5 / 8"	3 / 4"	7 / 8"	1"
Length	Key	Key	Key	Key	Key
(mm)	3 / 8"	1 / 2"	9 / 16"	9 / 16"	5 / 8"
3/8					
1/2					
5/8					
3/4	4225	10205			
7/8	4225	8700			
1	3685	8700	21695		
1-1/4	3685	7560	21695		
1-1/2	3755	7830	19120	28720	27430
1-3/4	4010	8330	19570	29820	28465
2	4010	8330	19570	29820	28465
2-1/4	4615	9045	19995	32150	30705
2-1/2	4615	9045	19995	32150	30705
2-3/4	5205	9935	22735	36205	34565
3	5205	9935	22735	36205	34565
3-1/4	7060	10630	23640	39920	38125
3-1/2	7060	10630	23640	39920	38125
4	8175	13760	24785	42130	40210
4-1/2	10240	14600	30050	49505	47245
5	12580	16525	32695	53195	50790
5-1/2	13855	20475	35305	56920	54325
6	14330	21345	37940	60610	57850
6-1/2		44915	49765	101605	96990
7		46230	50900	105590	91330
7-1/2		47300	52080	109035	104065
8		49215	53075	112670	107550
8-1/2		52270	55960	112670	110620
9			60130		117615

- | | | | |
|----|-----------------------|---|---|
| 1. | Specification | : | Generally conforming to BS:2470 |
| 2. | Threads | : | UNC 2A as per BS:1580 |
| 3. | Material | : | Special grade alloy steel |
| 4. | Mechanical Properties | : | As per BS:2470 |
| 5. | Note | : | Shaded sizes are fully threaded. |
| 6. | Finish | : | Thermal/ Chemical Blackened with rust preventive oil (Black colour) |



Socket Set Screws

Inch Series BSW

Knurled Cup Point

Recommended Retail Prices in Rupees Per 100 Piece



Diameter	3/16"	1/4"	5/16"	3/8"	1/2"
Length	Key	Key	Key	Key	Key
(Inch)	3/32"	1/8"	5/32"	5/16"	1/4"
3/16	265				
1/4	265	265			
5/16	265	295	295		
3/8	295	300	300	335	
1/2	305	310	310	375	640
5/8	310	335	350	420	695
3/4		355	375	455	730
1		430	455	540	830
1 1/4		585	610	780	1065
1 1/2					
1 3/4					
2					
2 1/2					
3					

1.	Specification	:	Generally conforming to BS:2470
2.	Threads	:	BS Fine, Medium fit as per BS:84, UNF ,Class 2A as per BS 1580
3.	Material	:	Special grade alloy steel
4.	Mechanical Properties	:	As per BS:2470
5.	Finish	:	Thermal/ Chemical Blackened with rust preventive oil (Black colour)
6.	Note	:	All sizes are fully threaded.
7.	Finish	:	BSW
		:	BSF/UNC/UNF On Enquiry



**Socket Countersunk
Head Cap Screws
Inch Series BSW (1/4" - 5/8")**
Recommended Retail Prices in Rupees Per 100 Piece

Diameter	1/4"	5/16"	3/8"	1/2"	5/8"
Length	Key	Key	Key	Key	Key
(mm)	5/32"	3/16"	7/32"	5/16"	5/16"
3/8	715				
1/2	715	1040			
5/8	780	1040	1610		
3/4	840	995	1455	3210	
7/8	905	1075	1565	3565	
1	980	1145	1690	4015	
1 - 1/4	1120	1305	1935	4455	
1 - 1/2		1745	2610	4985	
2			2920	5590	7100
2 1/2				6255	8190
3					9555

- | | | |
|---|---|--|
| 1. Specification | : | (Please refer to SFL technical data sheet. Page 7) |
| 2. Threads | : | BS Whitworth, Medium Fit as per BS:84 |
| 3. Material | : | Special grade alloy steel |
| 4. Mechanical Properties | : | Hardness 36-44 Hrc |
| 5. Note | : | All size are fully threaded |
| 6. Finish | : | Thermal/Chemical Blackend with rust preventive Oil(Black Colour) |
| These are not popular items. We will take up forging. after we get sufficient orders to meet out Economic batch run quantity. | | |



**Socket Countersunk
Head Cap Screws
Inch Series UNC (1/4" - 5/8")**
Recommended Retail Prices in Rupees Per 100 Piece

Diameter	1/4"	5/16"	3/8"	1/2"	5/8"
Length	Key	Key	Key	Key	Key
(mm)	5/32"	3/16"	7/32"	5/16"	5/16"
3/8	1185				
1/2	1185	1540			
5/8	1295	1540	2030		
3/4	1390	1650	2195	3925	
7/8	1490	1770	2335	4505	
1	1595	1825	2690	4900	
1 1/4	1830	2145	2815	5490	
1 1/2		2355	3235	6070	
2			3940	6675	7100
2 1/4				6910	7210
2 1/2				7345	8190
2 3/4				7695	8375
3				8075	9555

- | | | |
|--|---|---|
| 1. Specification | : | Generally conforming to BS:2470 |
| 2. Threads | : | UNC 2A as per BS: 1580 |
| 3. Material | : | Special grade alloy steel |
| 4. Mechanical Properties | : | Hardnesss 36 HRc Min |
| 5. Note | : | All sizes are fully threaded. |
| 6. Finish | : | Thermal/ Chemical Blackened with rust preventive oil (Black colour) |
| These are not popular items. We will take up forging after we get sufficient orders to meet our Economic batch run quantity. | | |



Socket Countersunk Head Cap Screws Inch Series BSF/UNF

Recommended Retail Prices in Rupees Per 100 Piece



Diameter	1/4"	5/16"	3/8"	1/2"
Length	Key	Key	Key	Key
(mm)	5/32"	3/16"	7/32"	5/16"
3/8	1205			
1/2	1205	1565		
5/8	1320	1565	2075	
3/4	1420	1690	2245	4000
7/8	1520	1810	2370	4595
1	1625	1855	2745	4990
1 - 1/4	1865	2180	2870	5595
1 - 1/2		2590	3300	6190
2			3940	6805
2 - 1/2				7485
3				8235

1. Specification : BSF/UNF: Generally conforming to BS: 2470
2. Threads : BS Fine, Medium fit as per BS:84 UNF, class 2A as per BS: 1580
3. Material : Special grade alloy steel
4. Mechanical Properties : Hardness 36 HRc Min
5. Note : All sizes are fully threaded.
6. Finish : Thermal/ Chemical Blackened with rust preventive oil (Black colour)
These are not popular items. We will take up forging.
after we get sufficient orders to meet our Economic batch run quantity.



Socket Head Cap Screws

Grade 8.8

Metric Series M3 - M12

Recommended Retail Prices in Rupees Per 100 Pieces



- 1. Specification : Generally conforming to IS:2269, DIN 912, ISO:4762
- 2. Threads : 10.9 Grade 6g as per ISO 261, ISO 965-2; ISO 965-3
- 3. Material : 10.9 Low Carbon boron steel, Medium carbon steel, Medium carbon boron steel, Special alloy steel
- 4. Mechanical Properties : 10.9, 12.9 As per ISO 898-1
- 5. Note : Sizes in brackets are non-preferred standards. Shaded sizes are fully threaded.
- 6. Finish : Thermal/ Chemical Blackened with rust preventive oil (Black colour)

Diameter	M3	M4	M5	M6	M8	M10	M12
Length	Key	Key	Key	Key	Key	Key	Key
(mm)	2.5mm	3mm	4mm	5mm	6mm	8mm	10mm
5	1480	1300	0	0	0	0	-
6	1275	1300	1505	1555	0	0	-
8	945	975	1050	1070	1310	0	-
10	790	775	590	615	1195	0	-
12	790	705	595	720	920	1365	-
(14)	825	730	680	695	805	1255	-
16	825	595	680	695	805	1255	3710
(18)	825	785	725	720	835	1155	3310
20	825	630	620	720	835	1155	3310
(22)	855	810	760	805	935	1260	2885
25	855	660	760	805	935	1260	2885
30	1005	960	885	905	1015	1385	2885
35		1050	965	985	1110	1500	2960
40		1150	1055	*1065	1195	1600	2975
45		1315	1140	*1155	*1280	1725	3025
50		1630	1235	*1235	*1340	*1840	3095
55		2595	2095	*1340	*1470	*1985	*3265
60			2685	2455	*1580	*2140	*3450
65			5325	2550	1675	2315	*3630
70			6385	2645	1795	2485	*3825
75				2945	1900	2640	*3995
80				3170	2860	4075	*4785
85				3410	3305	4640	*5410
90				3410	3305	4640	*5410
95				3845	3920	5450	*6265
100				3845	3920	5450	*6265
105				4605	4890	6440	*7510
110				4605	4890	6440	7510
115				6035	5705	6515	8650
120				5705	5705	6515	8650
125				7290	7015	8965	10505
130				7290	7015	8965	10505
135				8240	7530	10025	11695
140				8240	7530	10025	11695
145					8135	11130	12910
150					8135	11130	12910
155							21260
160							21260
165							23390
170							23390
175							23390
180							23390
185							25305
190							25305
195							25305
200							25305



Socket Head Cap Screws

Grade 8.8

Metric Series M14 - M24

Recommended Retail Prices in Rupees Per 100 Pieces



- 1. Specification : Generally conforming to IS:2269, DIN 912, ISO:4762
- 2. Threads : 8.8 Grade 6g as per ISO 261, ISO 965-2; ISO 965-3
- 3. Material : 8.8 Low Carbon boron steel, Medium carbon steel, Medium carbon boron steel, Special alloy steel
- 4. Mechanical Properties : 8.8 As per ISO 898-1
- 5. Note : Sizes in brackets are non-preferred standards. Shaded sizes are fully threaded.
- 6. Finish : 8.8 Grade with Zinc Phosphate & oil, Zinc Plate with Trivalent White/ Iridescent passivation prices will be against enquiry

Diameter	M14	M16	M18	M20	M22	M24
Length	Key	Key	Key	Key	Key	Key
(mm)	12mm	14mm	14mm	17mm	17mm	19mm
5						
6						
8						
10						
12						
(14)						
16						
(18)						
20	8310	7295				
(22)	7490	7295				
25	7490	7295		17810		
30	7490	7295	19595	17810		
35	6300	6135	19845	18040		
40	6455	6285	17375	15800		19055
45	6565	6395	17495	15915		19535
50	6715	6530	17640	16035	20495	18715
55	6795	6625	17750	16135	23040	21045
60	7205	*7015	17880	16245	23690	21640
65	7305	*7120	18040	16400	26385	24090
70	7885	7680	19270	17515	25600	24540
75	8330	8125	20515	*18655	29955	26000
80	8730	8500	20915	*19025	29955	27345
85	8925	8685	21340	19400	31405	28680
90	8925	8685	21340	19400	31405	28680
95	11070	10780	22380	20345	33130	30245
100	11070	10780	22380	20345	33130	30245
105	12030	11715	24765	22510	36010	32890
110	12030	11715	24765	22510	36010	32890
115	12995	12655	27125	24670	38920	35550
120	12995	12655	27125	24670	38920	35550
125	15050	14660	29510	26830	51170	38200
130	15050	14660	29510	26830	51170	38200
135	16110	15690	31870	28975	59790	40845
140	16110	15690	31870	28975	59790	40845
145	17180	16725	34235	31125	79705	43515
150	17180	16725	34235	31125	79705	43515
155	19295	33270	41785	39895	113990	70635
160	20245	33270	41785	39895	113990	70635
165		37050	47735	45555	121955	75580
170		37050	47735	45555	121955	75580
175		37050	47735	45555	121955	75580
180		37050	47735	45555	121955	75580
185		40945	49770	47500	130550	80900
190		40945	49770	47500	130550	80900
195		40945	49770	47500	130550	80900
200		40945	49770	47500	130550	80900



Socket Head Cap Screws/Bolts

Metric Series M16-M24 (Above 200mm length)

Metric Series M27-M36

Grade 8.8

Recommended Retail Prices in Rupees Per 100 Piece



Diameter	(M16)	(M20)	(M22)	(M24)	(M27)	M30	(M33)	M36
Length	Key	Key	Key	Key	Key	Key	Key	Key
(mm)	14mm	17mm	17mm	19mm	19mm	22mm	24mm	27mm
45						50985		
50						50985		
55						50985		
60						44680		
65						44680		
70					46445	44680		
(75)					46445	44680	67130	
80					46445	46445	69905	83530
90					50985	50985	75710	91095
100					54515	54515	79245	93625
110					57800	57800	83530	98915
120					61325	61325	91095	102960
130					61915	65615	95390	106485
140					68140	68140	101440	117580
150					72430	72430	106485	121885
160					114060	114060	141550	164510
(170)					126165	126165	156690	183185
180					126165	126165	156690	183185
(190)					137260	137260	170315	198575
200					137260	137260	170315	198575
(210)	42830	50435	137000	83745	171070	170315	211185	245500
220	42830	53375	143450	86575	171070	170315	211185	245500
(230)	44720	65645	149145	90020	189485	183185	227585	252305
240	44720	85380	154840	93445	189485	183185	227585	252305
(250)	46605	94335	160525	95440	216555	196055	237925	270225
260	46605	103280	166225	80660	206400	196055	237925	270225
(270)	48505	112820	171910	99645	220270	208920	251045	288130
280	48505	122345	177605	102485	220270	208920	251045	288130
(290)	50390	126720	183945	106310	234140	221775	270725	306040
300	50390	131090	190290	110155	234140	221775	270725	306040

1. Specification : Generally conforming to IS:2269, ISO:4762, DIN 912
2. Threads : ISO Metric, 5g6g for 12.9; 6g 8.8 & 10.9 as per ISO 261, ISO 965-2, ISO 965-3
3. Material : 8.8 Low Carbon boron steel, Medium carbon steel, Medium carbon boron steel, Special alloy steel
Property class as per ISO 898-1
4. Mechanical Properties : Sizes in brackets are non-preferred standards.
5. Note : 8.8 Grade - Thermal/ Chemical Blackened with rust preventive oil (Black colour)
6. Finish : 8.8 Grade - Zinc Phosphate & oil/ Zinc White Trivalent / Zinc Iridescent
Trivalent Passivation prices will be enquiry



Socket Button Head Cap Screws

Grade 8.8

Metric Series M3 - M10

Recommended Retail Prices in Rupees Per 100 Piece



Diameter	M3	M4	M5	M6	M8	M10
Length	Key	Key	Key	Key	Key	Key
(mm)	2mm	2.5mm	3mm	4mm	5mm	6mm
6	1090	705	1135			
8	1295	705	1080	1225		
10	1390	705	750	835	1350	
12	1490	750	780	680	1080	
16	1675	805	840	900	925	1745
20	1865	865	900	965	1160	1440
25	2045	1010	1055	1130	1330	1660
30		1215	1265	1295	1515	1900
35			1450	1480	1720	2175
40			1620	1685	1960	2495
45				2060	2260	2900
50					2490	3205

- | | | | |
|----|--------------------------|---|---|
| 1. | Specification | : | Generally conforming to ISO :7380-1 |
| 2. | Threads | : | 5g6g as per ISO 261; ISO 965-2;ISO 965-3 |
| 3. | Material | : | Special grade alloy steel |
| 4. | Mechanical Properties | : | Property class 8.8 as per ISO 898-1 |
| 5. | Tensile Load Requirement | : | 80% of the values specified in ISO 898-1 |
| 6. | Note | : | All sizes are fully threaded. |
| 7. | Finish | : | Thermal/ Chemical Blackened with rust preventive oil (Black colour) |



Socket Countersunk Head Cap Screws

Metric Series M3 - M20

Grade 8.8

Recommended Retail Prices in Rupees Per 100 Pieces



Diameter	M3	M4	M5	M6	M8	M10	M12	M16	M20
Length (mm)	Key	Key	Key	Key	Key	Key	Key	Key	Key
	2mm	2.5mm	3mm	4mm	5mm	6mm	8mm	10mm	17mm
6	1230								
8	1230	675	985	1180					
10	1315	675	555	755					
12	1415	570	570	610	985				
16	1600	770	770	765	985	1595			
20	1785	825	825	820	1050	1310			
25	1975	965	965	960	1210	1515	2760		
30		1155	1155	1150	1380	1730	3145	5370	
35		2390	1540	1530	1570	1985	3540	5785	
40		2565	2390	1540	1785	2270	3930	6185	6575
45		2900	2725	2725	2005	2565	4325	6600	7710
50		3405	3405	3405	3130	2880	4710	7015	7710
55					3740	3265	5110	7420	7350
60						3615	5505	7840	8850
65							6205	8630	9425
70							6670	9065	9980
75							7180	9510	11130
80							7725	9990	11130
85							8305	11320	12270
90							8945	11320	12270
95							9620	13690	14700
100							10355	13690	15750
110									18900
120									23100
130									25200

- | | | | |
|----|-----------------------|---|--|
| 1. | Specification | : | Generally conforming to IS:2269, DIN 912, ISO:4762 |
| 2. | Threads | : | ISO Metric, 6g as per IS:4218 |
| 3. | Material | : | Low & Medium Carbon Boron steel |
| 4. | Mechanical Properties | : | Property class 8.8 as per IS:1367 |
| 5. | Note | : | Sizes in brackets are non-preferred standards. |
| 6. | Finish | : | Blackened and coated with rust preventive oil |



Low Head Socket Head Cap Screws

Grade 8.8

Metric Series M4-M16

Recommended Retail Prices in Rupees Per 100 Pieces

Diameter	M4	M5	M6	M8	M10	M12	(M14)	(M16)
Length								
(mm)								
5								
6	1545							
8	1170	1195	1195					
10	925	825	805	1335				
12	835	835	805	1020				
(14)	880	770	765	895				
16	880	770	765	895	1405			
(18)	935	825	805	925	1285			
20	935	825	805	925	1285	3445		
(22)	970	885	895	1035	1410	3000		
25	970	885	895	1035	1410	3000	7805	
30		1020	1005	1135	1545	3000	7805	6000
35			1100	1235	1675	3070	6565	6385
40				1335	1785	3090	6710	6385
45						3150	6835	6455
50						3215	6985	6785

1.	Specification	:	Generally conforming to DIN 7984
2.	Threads	:	6g for 8.8 as per ISO 261 ; ISO 965-2
3.	Material	:	8.8 Grade Low Carbon boron Steel, Medium Carbon Steel. Medium carbon Boron Steel.
4.	Mechanical Properties	:	As per DIN EN ISO 898-1
5.	Note	:	Sizes in brackets are non-preferred standards
6.	Finish	:	Thermal/Chemical Blackend with rust preventive Oil(Black Colour).
7.	Tensile load requirement	:	80% of the values specified in DIN EN ISO 898-1
8.	Minimum batch quantity	:	M4 & M5 - 5000nos. M6 & M8 - 4000nos. M10 & M12 - 3000nos. M14 & 16 - 2000 Nos.



SOCKET KEYS - Metric Series

Recommended Retail Prices in Rupees Per 100 Piece



Sl.No.	Part No.	Size	Description	Qty. per box	Piece per 100 nos. Rs. P.
1	070000150	1.5 mm	Hex Socket Key	100	1215
2	070000200	2.0 mm	Hex Socket Key	100	1215
3	070000250	2.5 mm	Hex Socket Key	100	970
4	070000300	3.0 mm	Hex Socket Key	100	970
5	070000400	4.0 mm	Hex Socket Key	100	1920
6	070000500	5.0 mm	Hex Socket Key	100	2485
7	070000600	6.0 mm	Hex Socket Key	50	3300
8	070000700	7.0 mm	Hex Socket Key	50	9880
9	070000800	8.0 mm	Hex Socket Key	25	6045
10	070000900	9.0 mm	Hex Socket Key	25	15445
11	070001000	10.0 mm	Hex Socket Key	25	9880
12	070001200	12.0 mm	Hex Socket Key	10	15445
13	070001400	14.0 mm	Hex Socket Key	10	22015
14	070001700	17.0 mm	Hex Socket Key	10	37470
15	070001900	19.0 mm	Hex Socket Key	10	51705



SOCKET KEYS - Metric Series

Recommended Retail Prices in Rupees Per 100 Piece



Sl.No.	Part No.	Size	Description	Qty. per box	Piece per 100 nos. Rs. P.
16	070002200	22.0 mm	Hex Socket Key	5	90375
17	070002400	24.0 mm	Hex Socket Key	5	116810
18	070002700	27.0 mm	Hex Socket Key	5	204310
19	070003200	32.0 mm	Hex Socket Key	4	359305
20	070003600	36.0 mm	Hex Socket Key	4	546100
21	071000150	1.5 mm	Hex Socket Key (Long)	25	2070
22	071000200	2.0 mm	Hex Socket Key (Long)	25	2335
23	071000250	2.5 mm	Hex Socket Key (Long)	25	2335
24	071000300	3.0 mm	Hex Socket Key (Long)	25	2335
25	071000400	4.0 mm	Hex Socket Key (Long)	10	3615
26	071000500	5.0 mm	Hex Socket Key (Long)	10	4485
27	071000600	6.0 mm	Hex Socket Key (Long)	5	5625
28	071000800	8.0 mm	Hex Socket Key (Long)	5	7800
29	071001000	10.0 mm	Hex Socket Key (Long)	5	14850
30	078000000		Hex Socket Key (Metric - Norm) Set	10	30855



SOCKET KEYS - T Handle Hex

Recommended Retail Prices in Rupees Per 100 Piece



Sl.No.	Part No.	Size	Description	Qty. per box	Piece per 100 nos. Rs. P.
1	072000150	1.5 mm	T Handle Hex Socket Key (Long)	25	4135
2	072000200	2.0 mm	T Handle Hex Socket Key (Long)	25	4645
3	072000250	2.5 mm	T Handle Hex Socket Key (Long)	25	4645
4	072000300	3.0 mm	T Handle Hex Socket Key (Long)	25	4645
5	072000400	4.0 mm	T Handle Hex Socket Key (Long)	10	5415
6	072000500	5.0 mm	T Handle Hex Socket Key (Long)	10	6285
7	072000600	6.0 mm	T Handle Hex Socket Key (Long)	10	8450
8	072000800	8.0 mm	T Handle Hex Socket Key (Long)	10	11400
9	074000150	1.5 mm	T Handle Hex Socket Key (Short)	25	3110
10	074000200	2.0 mm	T Handle Hex Socket Key (Short)	25	3110
11	074000250	2.5 mm	T Handle Hex Socket Key (Short)	25	3110
12	074000300	3.0 mm	T Handle Hex Socket Key (Short)	25	3110
13	074000400	4.0 mm	T Handle Hex Socket Key (Short)	25	3615
14	074000500	5.0 mm	T Handle Hex Socket Key (Short)	25	4220
15	074000600	6.0 mm	T Handle Hex Socket Key (Short)	10	5875
16	074000800	8.0 mm	T Handle Hex Socket Key (Short)	10	8835
17	082000400	1/16 inch	T Handle Hex Socket Key (Long)	25	4135



SOCKET KEYS - Inch Series

Recommended Retail Prices in Rupees Per 100 Piece



Sl.No.	Part No.	Size	Description	Qty. per box	Piece per 100 nos. Rs. P.
1	080000400	1/16 inch	Hex Socket Key	100	1255
2	080000500	5/64 inch	Hex Socket Key	100	1255
3	080000600	3/32 inch	Hex Socket Key	100	1255
4	080000800	1/8 inch	Hex Socket Key	100	1255
5	080000900	9/64 inch	Hex Socket Key	100	2235
6	080001000	5/32 inch	Hex Socket Key	100	1495
7	080001200	3/16 inch	Hex Socket Key	100	1915
8	080001400	7/32 inch	Hex Socket Key	50	2715
9	080001600	1/4 inch	Hex Socket Key	50	3795
10	080002000	5/16 inch	Hex Socket Key	25	6230
11	080002400	3/8 inch	Hex Socket Key	25	9735
12	080003200	1/2 inch	Hex Socket Key	10	18565
13	080003600	9/16 inch	Hex Socket Key	10	23850
14	080004000	5/8 inch	Hex Socket Key	10	33180
15	081000400	1/16 inch	Hex Socket Key (Long)	25	2070
16	081000500	5/64 inch	Hex Socket Key (Long)	25	2070
17	081000600	3/32 inch	Hex Socket Key (Long)	25	2070
18	081000800	1/8 inch	Hex Socket Key (Long)	25	2070
19	081001000	5/32 inch	Hex Socket Key (Long)	10	2335
20	081001200	3/16 inch	Hex Socket Key (Long)	10	3025
21	081001400	7/32 inch	Hex Socket Key (Long)	10	3880
22	081001600	1/4 inch	Hex Socket Key (Long)	5	5520



SOCKET KEYS - Inch Series

Recommended Retail Prices in Rupees Per 100 Piece



Sl.No.	Part No.	Size	Description	Qty. per box	Piece per 100 nos. Rs. P.
23	082000500	5/64 inch	Hex Socket Key (Long)	25	4645
24	082000600	3/32 inch	Hex Socket Key (Long)	25	4645
25	082000800	1/8 inch	Hex Socket Key (Long)	25	4645
26	082001000	5/32 inch	Hex Socket Key (Long)	10	5160
27	082001200	3/16 inch	Hex Socket Key (Long)	10	5595
28	082001400	7/32 inch	Hex Socket Key (Long)	10	6440
29	082001600	1/4 inch	Hex Socket Key (Long)	10	8600
30	084000400	1/16 inch	Hex Socket Key (Long)	25	3110
31	084000500	5/64 inch	Hex Socket Key (Long)	25	3110
32	084000600	3/32 inch	Hex Socket Key (Long)	25	3110
33	084000800	1/8 inch	Hex Socket Key (Long)	25	3110
34	084001000	5/32 inch	Hex Socket Key (Long)	25	3370
35	084001200	3/16 inch	Hex Socket Key (Long)	25	3795
36	084001400	7/32 inch	Hex Socket Key (Long)	10	4395
37	084001600	1/4 inch	Hex Socket Key (Long)	10	5775
38	084002000	5/16 inch	Hex Socket Key (Long)	10	8070
39	088000000		Hex Socket Key (Inch-Norm) Set	10	33190

Specification :

Inch Series : Generally conforming to BS:2470
 Material : High grade alloy steel

Metric Series : IS 3082: ISO 2936: DIN 911
 Material : Special grade alloy steel

Mechanical Properties :

Hardness : 50 Hrc (3/8" & BELOW SIZE)
 Hardness : 45 Hrc (Above 3/8" SIZE)
 Finish : Blackened & Coated with rust preventive oil

Mechanical Properties :

Hardness : 50 Hrc (1.5mm to 8mm)
 : 48 Hrc (9mm to 14mm)
 : 45 Hrc (15mm to 36mm)
 Finish : Balckened & Coated with rust preventive oil

Note :

- Size stamped in plastic 'T' handle for easy identification
- Metric keys will have red plastic handle
- Inch key will have blue plastic handle



Chennai HO

C.Rajagopalan, Chennai
Vice President - Marketing
9840670546 / (044)28478500 Ext.460
rajagopalan.c@sfl.co.in

R.Vasudevan, Chennai
9840706124 / (044)28478500 Ext.456
vasudevan.r2@sfl.co.in

S.Ramachandran, Chennai
Wind Energy
9500057461
ramachandran.s@sfl.co.in

K.R.Raaghav, Chennai
Wind Energy
7358555285
raaghav.kr@sfl.co.in

V.Sadagopan, Chennai
9790900117 / (044)28478500 Ext.453
sadagopan.v@sfl.co.in

N.Jambunathan, Chennai
9176159004 / (044)28478500 Ext.244
jambunathan.n@sfl.co.in

G.Karthik Raja, Chennai
7550022002 / (044)28478500 Ext.454
karthikraja.g@sfl.co.in

K.Viruthika, Chennai
7550079001 / (044)28478500 Ext.244
viruthika.k@sfl.co.in

North Zone:

Sanjay Sachdev, Delhi
9384016498
sanjay.sachdev@sfl.co.in

Vikas Malhotra, Delhi
9871794185
vikas.malhotra@sfl.co.in

Sandeep, Delhi
9268503824
sandeep@sfl.co.in

Navin Krishna, Kanpur
9935521232
navin.krishna@sfl.co.in

Manu Kumar Sharma, Varanasi
9384020766
manukumar.sharma@sfl.co.in

Amit Kumar Roushan, Jaipur
9677113353
amitkumar.roushan@sfl.co.in

Vineet Purohit, Jalandhar
9384020771
vineet.purohit@sfl.co.in

East Zone:

Debasish Paik, Kolkata
9831000184
paik.d@sfl.co.in

Dibyendu Sen, Kolkata
9831958896
sen.d@sfl.co.in

Sumit Lahiri, Siliguri
9401726521
sumit.lahiri@sfl.co.in

Akshayakumar Ray, Cuttack
9437562201
akshayakumar.ray@sfl.co.in

Piyush Kamal Upadhyay, Patna
9162988453
piyush.kamal@sfl.co.in

Rajat Dey, Guwahati
9864023336
rajat.dey@sfl.co.in

West Zone:

Harish Manchanda, Indore
9384020765
harish.manchanda@sfl.co.in

Saish Chavali, Pune
9384020769
saish.chavali@sfl.co.in

Rajeev Suhane, Raipur
9384020768
rajeev.suhane@sfl.co.in

Sharad Jain, Jabalpur
9384020770
sharad.jain@sfl.co.in

D.Murugan, Nasik
9552574432
murugan.d@sfl.co.in

Pranshu Arora, Vadodara
9384020767
pranshu.arora@sfl.co.in

Sangram K.Save, Mumbai
9384020762
sangram.save@sfl.co.in

Kaushal Shah, Ahmedabad
9150938887
kaushal.shah@sfl.co.in

South Zone:

G.Kumaran, Bengaluru
9886423351
kumaran.g@sfl.co.in

Syed Vazeeruddin, Vijayawada
9384016499
syed.vazeeruddin@sfl.co.in

S.Selva Kumar, Chennai
7338854264 / (044) 28478500
Extn.470
selvakumar.s2@sfl.co.in

Elias Mathew, Ernakulam
9061061401
elias.mathew@sfl.co.in

Registered Office

98A, 7th Floor, Dr.Radhakrishnan Salai,
Mylapore, Chennai – 600 004, India.
Tel: +91-44-2847 8500
Fax: +91-44-2847 8508

Marketing Office

98A, 7th Floor, Dr.Radhakrishnan Salai,
Mylapore, Chennai – 600 004, India.
Tel: +91-44-2847 8500
Fax: +91-44-2847 8508

Factories

Padi,
Chennai – 600 050, India.
Tel : +91-44-26258460
Fax : +91-44-26257493

Korkadu, Villianur (Via)
Pondicherry – 605 110, India.
Tel :+91 -413-2666440
Fax :+91-413-2666441

Krishnapuram,
Aviyur – 626 160, India.
Tel :+91-4566-255466 / 7
Fax : +91-4566-255448

Uttarkhand
Plot No.60 Sector 11,
Integrated Industrial Estate,
Pantnagar, Rudrapur 263153.
Tel: +91-5944-250177

WEF & Infra Unit
135/3, 136/1 - Mandagapattu Road,
Mitta Mandagapattu Village,
Villupuram Dist. - 605 106, Tamilnadu.
Tel: +91-413-2697691 / 92
Fax:+91-413-2665441